

LEAF HINGE

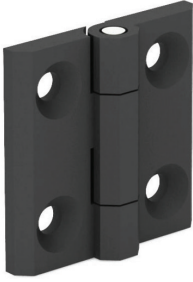

Specifications

- Material:
Body: Polyamide DIN-EN ISO 1043-1 PA6 GFR 30
Pin: Stainless Steel
- Maximum hinge rotation 270°

Features

- Generally used for plain / flush-mounted doors
- Stud versions fitted with M6 x 12 mm threaded stud
- Stainless steel (AISI 304) hinge pin
- Applications: Electric panels, built-in covers

Hinge Rotation Angle

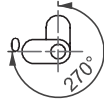

Version 1

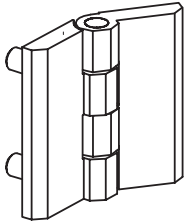

Version 2

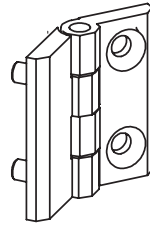

Version 3

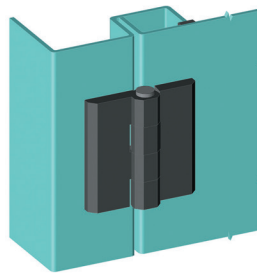
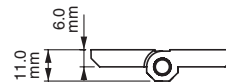
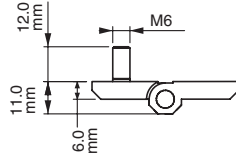
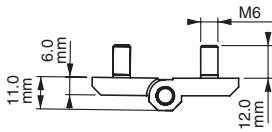
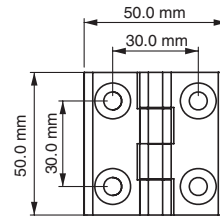
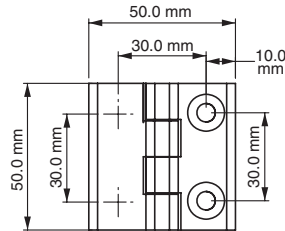
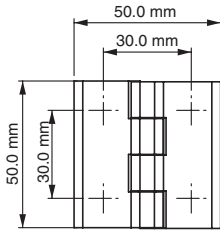
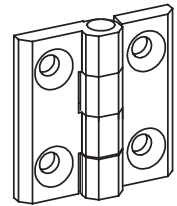

Item Number	Hinge Rotation	Material	Finish	Version
199201	270°	Nylon	Black	1
199202	270°	Nylon	Black	2
199203	270°	Nylon	Black	3